

Full Port Stainless Steel Ball Valves

Features:

- for use in water, oil and gas
- ¼" - 2" rated to **1000 PSI** WOG (CWP); 2½" - 3" rated to **800 PSI** WOG (CWP); **100 PSI** saturated steam
- 316 stainless steel body, ball and stem
- PTFE seat, joint gasket and thrust washer
- private label handle covers available, see page 218
- blow-out proof stem design
- full port
- temperature range **-20°F to 300°F**

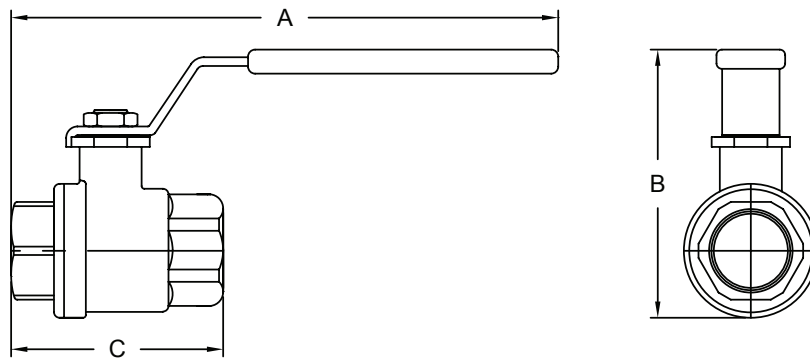

Size	A	B	C	316 Stainless Steel Part Number
¼"	5.25	2.75	1.25	SSBV25
⅜"	5.25	3.00	2.25	SSBV38
½"	6.50	3.25	2.75	SSBV50
¾"	6.75	3.50	3.00	SSBV75
1"	8.25	4.00	3.50	SSBV100
1¼"	8.75	4.50	4.00	SSBV125
1½"	9.75	5.00	4.50	SSBV150
2"	10.00	5.75	5.00	SSBV200
2½"	13.50	7.75	6.50	SSBV250
3"	14.00	8.50	7.00	SSBV300



All dimensions are in inches unless otherwise noted. Engineering dimensions are available upon request.
Specifications are subject to change without notice.