

# Dixon Sanitary Tube Hangers

## Complete Support

## Product Specific tions

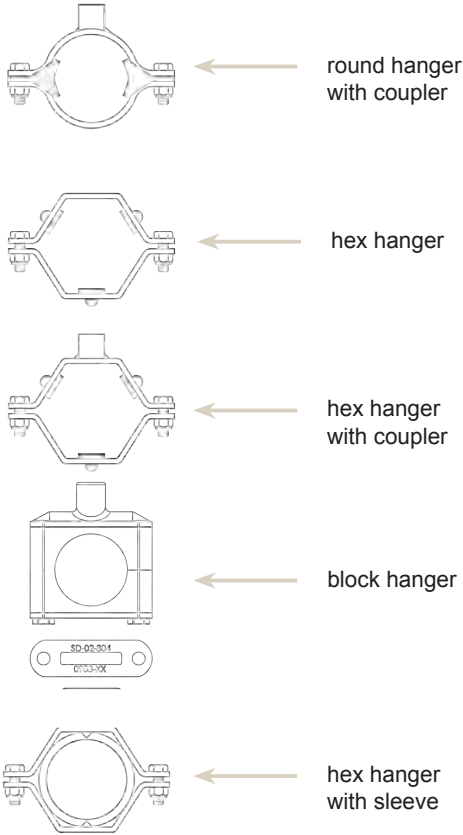

### Size range:

- ½" - 12" OD tube

### Materials:

- hanger base: 304 stainless steel
- hanger inserts: nitrile..... rated to 230°F  
 ABS (sleeve) ..... 230°F  
 FKM..... 400°F  
 Polypropylene ..... 212°F  
 Polysulfone..... 325°F  
 Silicone..... 320°F

Tube OD	Nominal Wall Thickness (inches)	Gage Number
½"	.065	16
¾"	.065	16
1"	.065	16
1½"	.065	16
2"	.065	16
2½"	.065	16
3"	.065	16
4"	.083	14
5"	.109	12
6"	.109	12
8"	.120	10
10"	.109	12
12"	.120	10

## Support Recommendations

Lines are not to be rigidly anchored to equipment. Lines must be allowed to float. Temperatures cause expansion and contraction and if mounted incorrectly will cause distortion and possibly leakage.

### Proper Installation:

- straight sections need support every 10 feet
- each side of every valve (as close as possible to the connection) needs support
- support each change of directions

## Index

Hex Hangers.....	111-113	Round Hangers .....	113
Grommets.....	112	Block Hangers .....	114-115
Nuts and Bolts .....	112	Wall Flanges.....	115
Sleeves.....	113		

**K**

## Tube Hex Hangers

### Hex Hanger with Nitrile Grommets - B24RG

**Features:**

- Nitrile grommets maximum temperature: **230°F**
- All hex and round style hangers can be equipped with the following coupler options:
  - 3/8 NPT
  - all thread: 3/8-16 or 1/2-13

Tube OD	A	B	304 Stainless Steel Part Number
1/2" - 3/4"	3.425	1.450	<b>B24RG-G75</b>
1"	3.425	1.450	<b>B24RG-G100</b>
1 1/2"	4.000	2.125	<b>B24RG-G150</b>
2"	4.500	2.500	<b>B24RG-G200</b>
2 1/2"	4.950	3.125	<b>B24RG-G250</b>
3"	5.500	3.750	<b>B24RG-G300</b>
4"	6.950	4.750	<b>B24RG-G400</b>
5"	8.000	5.625	<b>B24RG-G500</b>
6"	9.250	6.625	<b>B24RG-G600</b>
8"	11.500	8.625	<b>B24RG-G800</b>
10"	14.500	10.500	<b>B24RG-G1000</b>
12"	16.750	12.625	<b>B24RG-G1200</b>

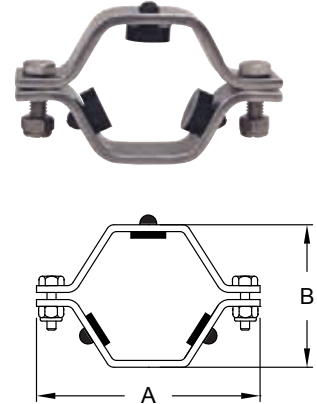

### Hex Hanger with FKM Grommets - B24RGSFY

**Features:**

- FKM grommets maximum temperature: **392°F**
- All hex and round style hangers can be equipped with the following coupler options:
  - 3/8 NPT
  - all thread: 3/8-16 or 1/2-13

Tube OD	A	B	304 Stainless Steel Part Number
1/2"	3.625	2.125	<b>B24RGSFY-G50</b>
3/4"	3.625	2.125	<b>B24RGSFY-G75</b>
1"	3.625	2.125	<b>B24RGSFY-G100</b>
1 1/2"	3.625	2.125	<b>B24RGSFY-G150</b>
2"	4.313	2.625	<b>B24RGSFY-G200</b>
2 1/2"	4.875	3.125	<b>B24RGSFY-G250</b>
3"	5.375	3.625	<b>B24RGSFY-G300</b>
4"	6.563	4.750	<b>B24RGSFY-G400</b>
6"	9.000	6.625	<b>B24RGSFY-G600</b>
8"	11.250	8.750	<b>B24RGSFY-G800</b>
10"	14.500	10.500	<b>B24RGSFY-G1000</b>
12"	16.750	12.625	<b>B24RGSFY-G1200</b>

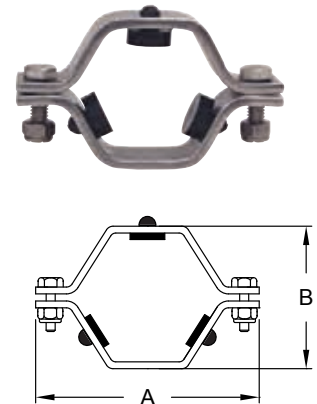

**K**

### Hex Hanger with Nitrile Grommets and Coupler - B24RGC

**Features:**

- Nitrile grommets maximum temperature: **230°F**
- Coupler has 3/8 NPT

Tube OD	A	B	C	304 Stainless Steel Part Number
1/2" - 3/4"	3.425	1.450	.750	<b>B24RGC-G75</b>
1"	3.425	1.450	.750	<b>B24RGC-G100</b>
1 1/2"	4.000	2.125	.750	<b>B24RGC-G150</b>
2"	4.500	2.500	.750	<b>B24RGC-G200</b>
2 1/2"	4.750	3.125	.750	<b>B24RGC-G250</b>
3"	5.500	3.750	.750	<b>B24RGC-G300</b>
4"	6.750	4.750	.750	<b>B24RGC-G400</b>
6"	9.250	6.625	.750	<b>B24RGC-G600</b>
8"	11.500	8.625	.750	<b>B24RGC-G800</b>

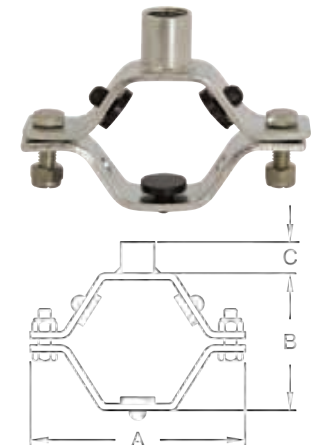

## Tube Hex Hangers

### Hex Hanger with Nitrile Grommets and All Thread Coupler - B24RGC16

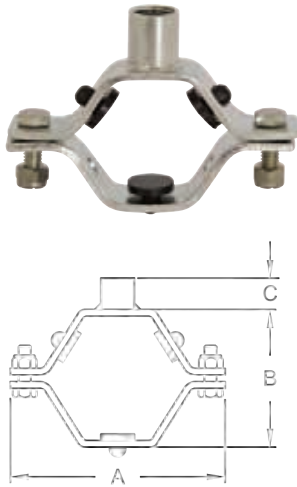

**Features:**

- Nitrile grommets maximum temperature: 230°F
- Coupler is all thread 3/8-16

Tube OD	A	B	C	304 Stainless Steel Part Number
1/2" - 3/4"	3.425	1.450	.750	<b>B24RGC16-G75</b>
1"	3.425	1.450	.750	<b>B24RGC16-G100</b>
1 1/2"	4.000	2.125	.750	<b>B24RGC16-G150</b>
2"	4.500	2.500	.750	<b>B24RGC16-G200</b>
2 1/2"	4.750	3.125	.750	<b>B24RGC16-G250</b>
3"	5.500	3.750	.750	<b>B24RGC16-G300</b>
4"	6.750	4.750	.750	<b>B24RGC16-G400</b>
6"	9.250	6.625	.750	<b>B24RGC16-G600</b>
8"	11.500	8.625	.750	<b>B24RGC16-G800</b>

## K



### Nuts and Bolts - 13NHN

**Features:**

- All sizes hex hangers with grommets and round hangers 1" to 4" use 13NHN-G100-600 fastener sets
- 1/2" and 3/4" round and sleeved hangers use 13NHN-G75 fastener sets
- 2 nuts and bolts supplied to a set

Size	Description	304 Stainless Steel Part Number
1/2" - 3/4"	1/4-20 x 3/4" bolt with nylock nut	<b>13NHN-G75</b>
1" - 12"	5/16-18 x 1" bolt with nylock nut	<b>13NHN-G100-600</b>

### Grommets - 13RG

**Features:**

- Nitrile grommets maximum temperature: 230°F
- FKM grommets maximum temperature: 392°F

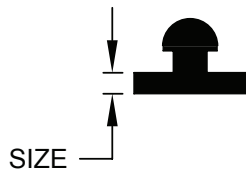

Size	Nitrile Part Number	FKM Part Number
1/8" <sup>1</sup>	<b>13RG18</b>	<b>13RGV18</b>
1/4"	<b>13RG14</b>	<b>13RGV14</b>
1/2"	<b>13RG12</b>	<b>13RGV12</b>
3/8" <sup>2</sup>	<b>13RG38</b>	<b>13RGV38</b>
5/8"	<b>13RG58</b>	<b>13RGV58</b>

<sup>1</sup> for 1" hangers and larger

<sup>2</sup> for 1/2" and 3/4" hangers

## Tube Hex Hangers

### Hex Hanger with ABS Sleeve - B24PS

**Feature:**

- ABS sleeve maximum temperature: 230°F

Tube OD	A	B	304 Stainless Steel Part Number
1/2"	2.800	1.150	<b>B24PS-G50</b>
3/4"	2.800	1.150	<b>B24PS-G75</b>
1"	3.425	1.450	<b>B24PS-G100</b>
1 1/2"	4.000	2.125	<b>B24PS-G150</b>
2"	4.500	2.500	<b>B24PS-G200</b>
2 1/2"	4.950	3.125	<b>B24PS-G250</b>
3"	5.500	3.750	<b>B24PS-G300</b>
4"	6.950	4.750	<b>B24PS-G400</b>
5"	8.063	5.625	<b>B24PS-G500</b>
6"	9.250	6.625	<b>B24PS-G600</b>
8"	11.500	8.625	<b>B24PS-G800</b>
10"	14.500	10.500	<b>B24PS-G1000</b>
12"	16.625	13.000	<b>B24PS-G1200</b>

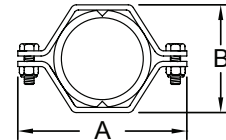

### Hex Hanger with High Temperature Polysulfone Sleeve - B24HS

**Feature:**

- High temperature sleeve maximum temperature: 325°F

Tube OD	A	B	304 Stainless Steel Part Number
1/2"	2.375	1.062	<b>B24HS-G50</b>
3/4"	2.625	1.188	<b>B24HS-G75</b>
1"	2.688	1.563	<b>B24HS-G100</b>
1 1/2"	3.625	2.125	<b>B24HS-G150</b>
2"	4.625	2.625	<b>B24HS-G200</b>
2 1/2"	4.813	3.125	<b>B24HS-G250</b>
3"	5.375	3.625	<b>B24HS-G300</b>
4"	6.625	4.625	<b>B24HS-G400</b>
6"	9.000	6.625	<b>B24HS-G600</b>

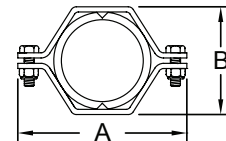

**K**

### Sleeves - 13\*S

**Features:**

- ABS sleeve maximum temperature: 230°F
- High temperature sleeve maximum temperature: 325°F

Size	ABS Part Number	High Temperature Part Number
1/2"	<b>13PS-50</b>	<b>13HS-50</b>
3/4"	<b>13PS-75</b>	<b>13HS-75</b>
1"	<b>13PS-100</b>	<b>13HS-100</b>
1 1/2"	<b>13PS-150</b>	<b>13HS-150</b>
2"	<b>13PS-200</b>	<b>13HS-200</b>
2 1/2"	<b>13PS-250</b>	<b>13HS-250</b>
3"	<b>13PS-300</b>	<b>13HS-300</b>
4"	<b>13PS-400</b>	<b>13HS-400</b>
5"	<b>13PS-500</b>	---
6"	<b>13PS-600</b>	<b>13HS-600</b>
8"	<b>13PS-800</b>	---
10"	<b>13PS-1000</b>	---
12"	<b>13PS-1200</b>	---



### Round Hanger with Nitrile Inserts - B24RPH

**Features:**

- Nitrile inserts maximum temperature: 230°F
- All hex and round style hangers can be equipped with the following coupler options: 3/8 NPT or all thread: 3/8-16 or 1/2-13

Tube OD	A	B	304 Stainless Steel Part Number
1/2"	2.750	1.125	<b>B24RPH-G50</b>
3/4"	2.750	1.125	<b>B24RPH-G75</b>
1"	3.310	1.500	<b>B24RPH-G100</b>
1 1/2"	3.810	2.000	<b>B24RPH-G150</b>
2"	4.250	2.562	<b>B24RPH-G200</b>
2 1/2"	5.000	3.000	<b>B24RPH-G250</b>
3"	5.500	3.562	<b>B24RPH-G300</b>
4"	6.500	4.688	<b>B24RPH-G400</b>

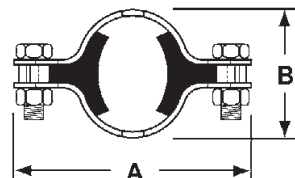

## Tube Uni-Hinge Block Hangers

2014  
**NEW**



### Features:

- support range: 1½" - 4", optional 6" - contact Dixon Sanitary

### Materials:

- silicone insert - 80 durometer
- intermittent temperatures from -40°F to 320°F
- hardware - 304 & 316 stainless steel

### Applications:

- clean rooms and mechanical areas; not limited to: biotech, pharmaceutical, food processing.
- low flow & low pressure systems with moderate vibration: WFI, SIP, CIP, process, utility & instrument lines.

### Benefits

- insulation envelope: reduced OD allows hanger to be buried under the insulation jacket.
- silicone inserts are one piece
- there are no exposed threads or openings in hardware plates
- all plates polished, bolts are cleaned and nuts are lubricated with FDA approved product
- hanger threads match MSS SP-69 rod OD requirements

## Hang Plate Block Hanger - B24-HP

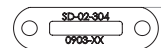
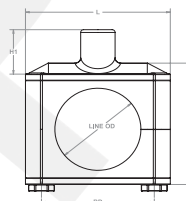

Pipe Size	BD	H	H1	L	Line OD	W	Thread	Part Number
½"	1.44	1.69	0.60	1.93	0.50	0.75	3/8"-16	<b>B24-HP-G050</b>
¾"	1.44	1.69	0.60	1.93	0.75	0.75	3/8"-16	<b>B24-HP-G075</b>
1"	1.44	1.69	0.60	1.93	1.00	0.75	3/8"-16	<b>B24-HP-G100</b>
1½"	1.94	2.19	0.60	2.49	1.50	0.75	3/8"-16	<b>B24-HP-G150</b>
2"	2.44	2.69	0.60	2.99	2.00	0.88	1/2"-13	<b>B24-HP-G200</b>
2½"	2.81	3.22	1.21	3.36	2.50	0.88	1/2"-13	<b>B24-HP-G250</b>
3"	3.44	3.97	1.21	3.99	3.00	0.88	1/2"-13	<b>B24-HP-G300</b>
4"	4.55	4.85	1.39	5.10	4.00	1.00	5/8"-11	<b>B24-HP-G400</b>

## Weld Plate Block Hanger - B24-WP

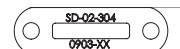
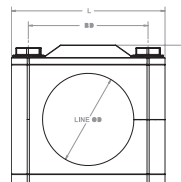

Pipe Size	BD	CL	H	L	Line OD	W	Part Number
½"	1.44	0.79	1.73	1.93	0.50	0.75	<b>B24-WP-G050</b>
¾"	1.44	0.79	1.73	1.93	0.75	0.75	<b>B24-WP-G075</b>
1"	1.44	0.79	1.73	1.93	1.00	0.75	<b>B24-WP-G100</b>
1½"	1.94	1.03	2.23	2.49	1.50	0.75	<b>B24-WP-G150</b>
2"	2.44	1.31	2.75	2.99	2.00	0.88	<b>B24-WP-G200</b>
2½"	2.81	1.55	3.25	3.36	2.50	0.88	<b>B24-WP-G250</b>
3"	3.44	1.93	3.68	3.99	3.00	0.88	<b>B24-WP-G300</b>
4"	4.55	2.39	4.87	5.10	4.00	1.00	<b>B24-WP-G400</b>